

## SECUMAX 145

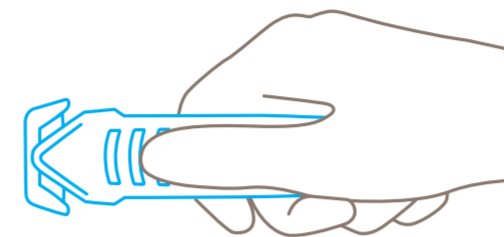

### USAGE



For the best possible grip, place your thumb on the **grooved surface**.

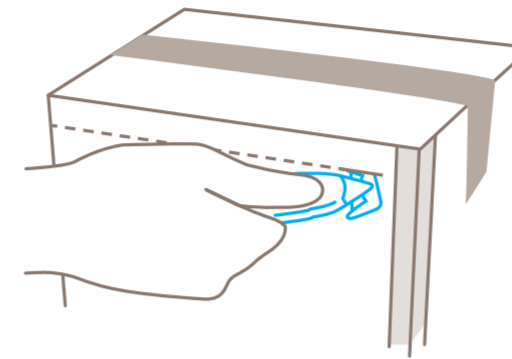

**Pierce** into the cutting material using the pointed nose of the knife.

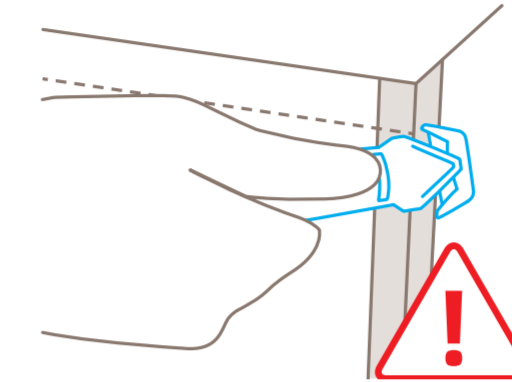

**Do not lever** against staples, or force into edge protectors!

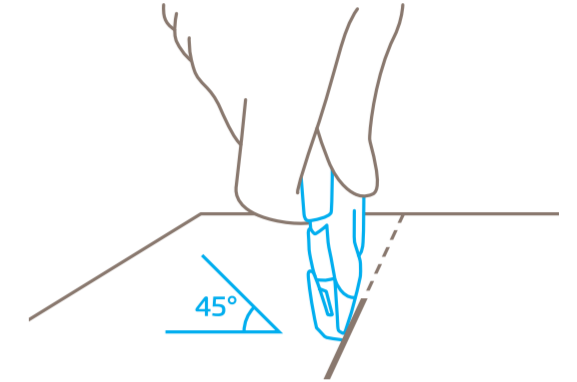

Hold the knife at a **slight angle** when cutting open cardboard boxes.

### USAGE

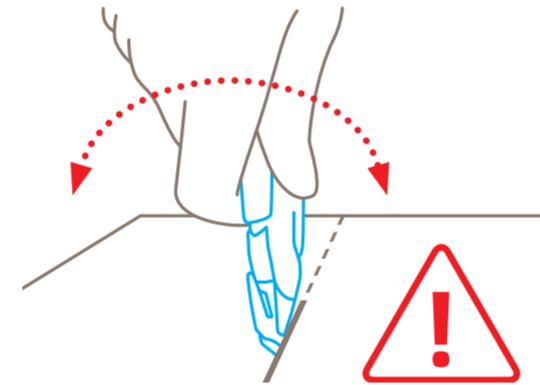

If the blade head gets stuck, **don't forcefully lever** the knife!

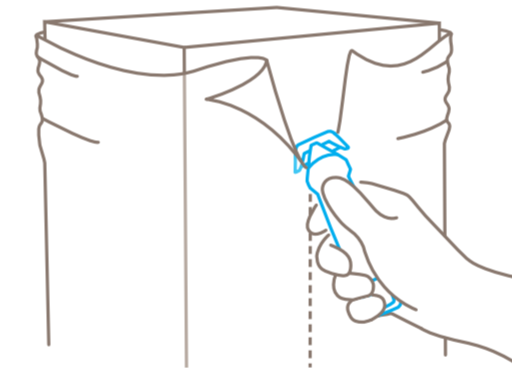

Use the **pointed nose** of the knife to pierce the film.

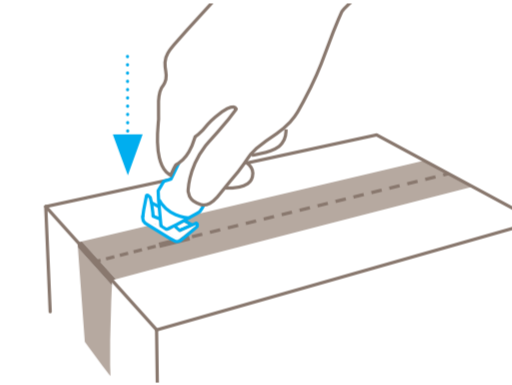

Pierce into cardboard adhesive tape using the **flat edges** on top of the blade head.

### PROTECTION OF USER

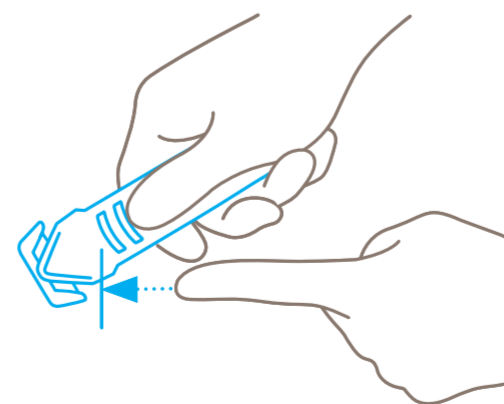

The concealed blade provides maximum protection from **cut injuries**.

### PROTECTION OF GOODS

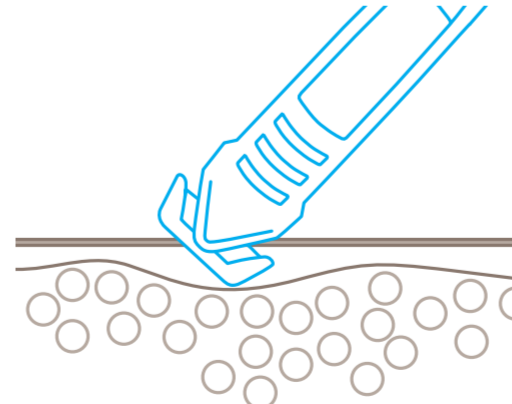

The concealed blade **will not get into contact with your goods** either.

### DISPOSAL

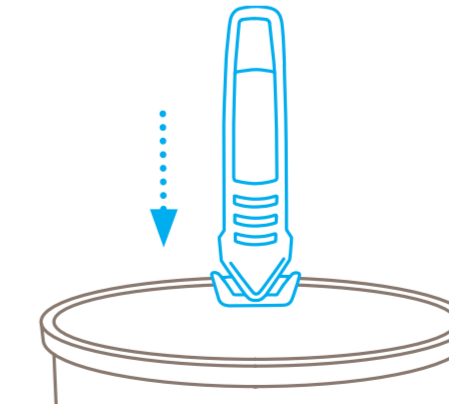

The SECUMAX 145 is a disposable knife that can be safely disposed of **with your general waste**.

**Please note:** To ensure your product always functions flawlessly, regularly remove any impurities. For additional safety, we recommend wearing gloves.